

SECTIONAL VIEWS

No: 0PLA08D5031-00

MODEL: LA-2250 & LA-2260 (Stand types)

3Ø

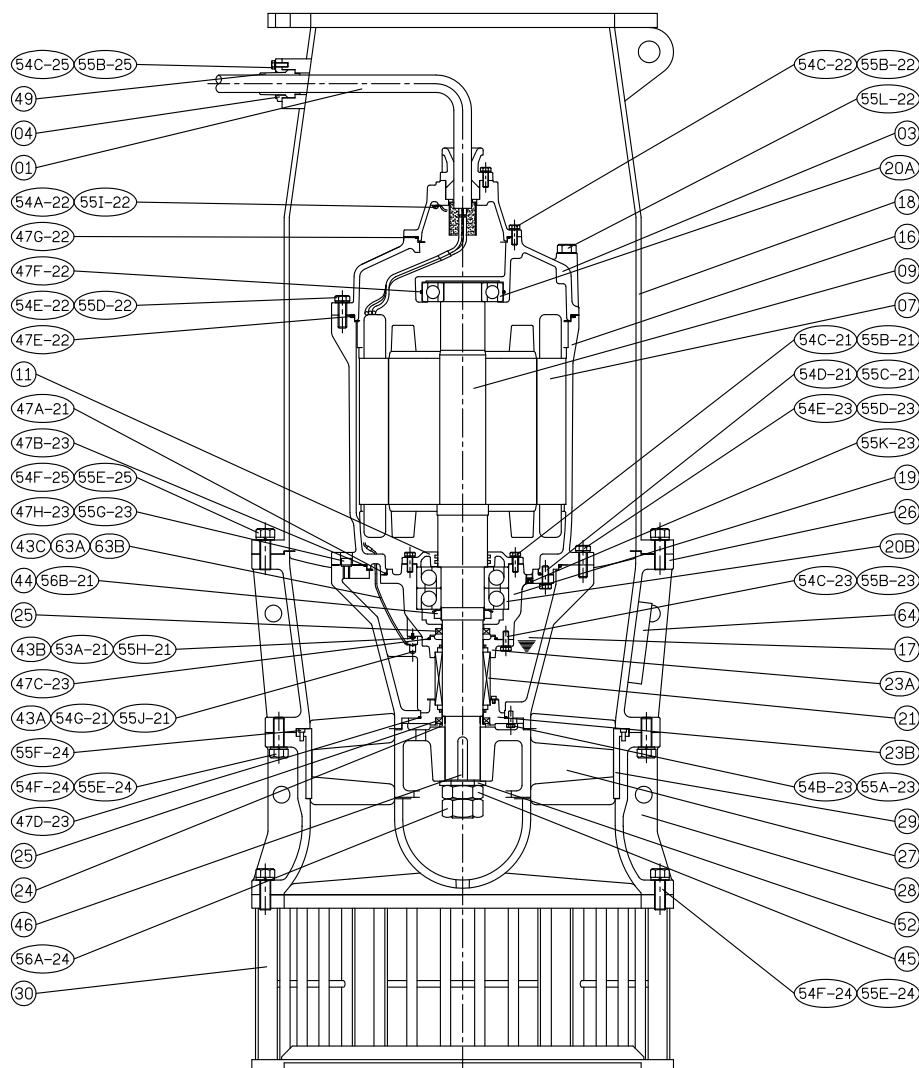

No.	Part name	Material	QTY	Remark
01	Cable		1	
03	Upper cover	FC200	1	
07	Stator		1	
09	Shaft end	SUS420J2	1	
11	Bearing fixer	FC200	1	
16	Motor frame	FC200	1	
17	Lubricant			
18	Outer cover	SS400	1	
19	Bearing bracket	FC200	1	
20A	Bearing		1	
20B	Bearing		1	
21	M.seal	SIC / SIC & SIC / SIC	1	
23A	M. seal bracket	FC200	1	

No.	Part name	Material	QTY	Remark
23B	M. seal bracket	FC200	1	
24	Oil seal bush	SUS304	1	
25	Oil seal	NBR	2	
26	Casing	FC200	1	
27	Impeller	SCS13	1	
28	Casing cover	FC200	1	
29	Wear ring	SCS13	1	
30	Footing	SS400	1	
43	Moisture sensor		1	
46	Impeller key	SUS304	1	
47	Packing			
64	Sacrificial aluminum anode plate	Al	1	

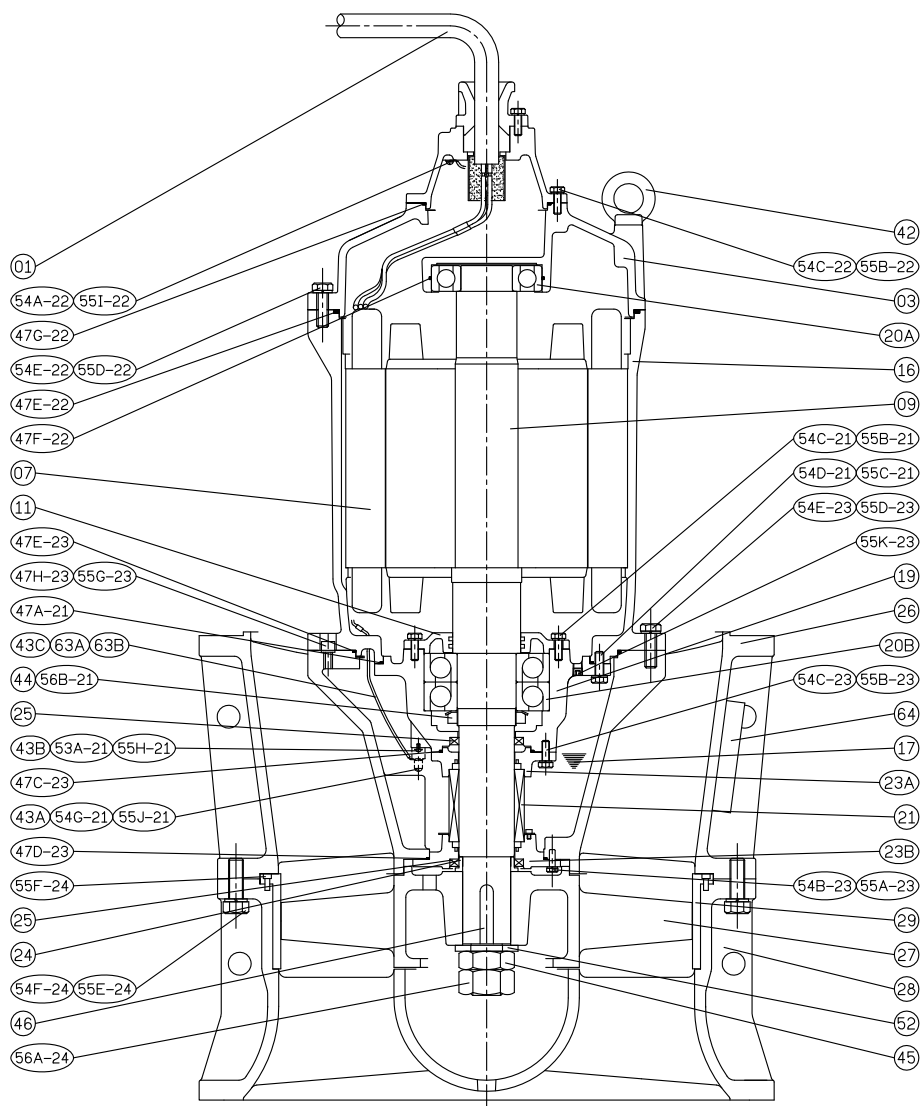

No.	Part name	Material	QTY	Remark
01	Cable		1	
03	Upper cover	FC200	1	
07	Stator		1	
09	Shaft end	SUS420J2	1	
11	Bearing fixer	FC200	1	
16	Motor frame	FC200	1	
17	Lubricant			
19	Bearing bracket	FC200	1	
20A	Bearing		1	
20B	Bearing		1	
21	M.seal	Sic / Sic & Sic / Sic	1	
23A	M. seal bracket	FC200	1	
23B	M. seal bracket	FC200	1	

No.	Part name	Material	QTY	Remark
24	Oil seal bush	SUS304	1	
25	Oil seal	NBR	2	
26	Casing	FC200	1	
27	Impeller	SCS13	1	
28	Casing cover	FC200	1	
29	Wear ring	SCS13	1	
43	Moisture sensor		1	
46	Impeller key	SUS304	1	
47	Packing			
64	Sacrificial aluminum anode plate	Al	1	